

TR 5000

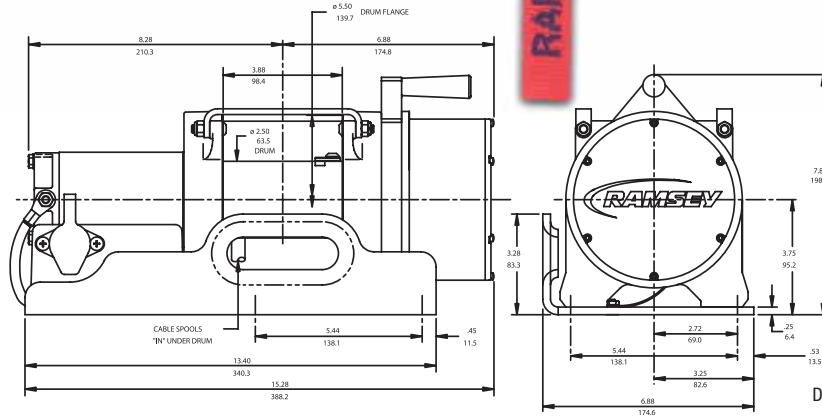

Product Features

- Proven three-stage planetary gear system design for fast line speed
- Automatic load-holding brake
- Cam action clutch disengages planetary gear system for free spooling
- Weather resistant solenoid assembly
- 12 ft pendant
- 5 ft (1.83 m) 4 gauge battery cables with connectors
- Mounting platform with hawse fairlead
- Cable tensioner
- Limited lifetime warranty

Specifications

Rated line pull (single line) 5,000 lb (2,260 kg)
 Gear reduction ratio . . . 294:1
 Motor Permanent magnet 1.3 hp (12V)
 Overall dimensions . . . (LxWxH) 15.28" x 6.88" x 7.70"
 (388 mm x 175 mm x 196 mm)
 Drum size Diameter 2.5" (63 mm) Length 3.9" (99 mm)
 Weight 47 lb (21.3 kg) winch, cable, mounting platform
 w/fairlead and hook
 Cable supplied 50 ft (15 m) of 1/4" (6 mm) galvanized aircraft cable
 with replaceable clevis hook with safety latch
 Mounting bolt pattern . . . 5.44 ± .015 in. x 5.44 ± .015 in.
 (138,2 mm x 138,2 mm)

Line Speed and Amp Draw – First Layer

Line Pull	lb	kg	no load	1,000	3,000	5,000
Line Speed	fpm	mpm	15	11	8	5
Motor Current	amps @ 12V		4.5	3.3	2.4	1.5
			45	100	155	230

Line Pull and Cable Capacity

Layer of Cable		1	2	3	4
Rated Line Pull per Layer	lb	5,000	4,200	3,600	3,200
	kg	2,260	1,900	1,630	1,450
Cable Capacity per Layer	ft	10	20	35	50
	m	3.0	6.1	10.7	15.2

TR 5000 H 12V **Part# 111099**

H - Hawse fairlead

Note: Winch is not designed for and should not be used in Industrial or Commercial applications.