

## 4. Performance Data, Dimensions, Order Codes

### Motor

	motor G096		motor G0107	
maximum pressure	2700 psi	185 bar*	2500 psi	175 bar*
maximum return flow pressure	200 psi	14 bar	200 psi	14 bar
maximum back pressure	175 psi	12 bar	175 psi	12 bar
maximum case drain pressure	200 psi	14 bar	200 psi	14 bar
maximum oil flow	69 USGPM	260 l/min	77 USGPM	289 l/min
minimum oil flow	7 USGPM	17 l/min	7 USGPM	27 l/min
weight (drum 309)	421 lbs	191 kg	421 lbs	191 kg

\*including 10 bar return flow pressure allowance.  
For other return flow pressure values adjust maximum pressure accordingly.  
For other motor variants, please refer to factory.

### Drum

DRUM options		standard drum			
rope diameter range		3/8" - 5/8" / 10 - 16 mm			
imperial data based on rope diameter		5/8"			
metric data based on rope diameter		16 mm			
rope layer		<b>1</b>	<b>2</b>	<b>3</b>	<b>4</b>
max. hoisting force	lbs	13000	11700	10600	9800
	kN	57	52	47	43
max. rope speed	ft/min	144	159	175	191
	m/min	44	49	54	58
accumulated rope storage	ft	56	117	183	255
	m	17	35	55	77

  

DRUM groove options		standard drum		
rope diameter		16 mm		
rope layer		<b>1</b>	<b>2</b>	<b>3</b>
max. hoisting force	lbs	12300	11100	10200
	kN	54	49	45
max. rope speed	ft/min	152	167	183
	m/min	46	51	56
accumulated rope storage	ft	56	117	183
	m	17	35	55

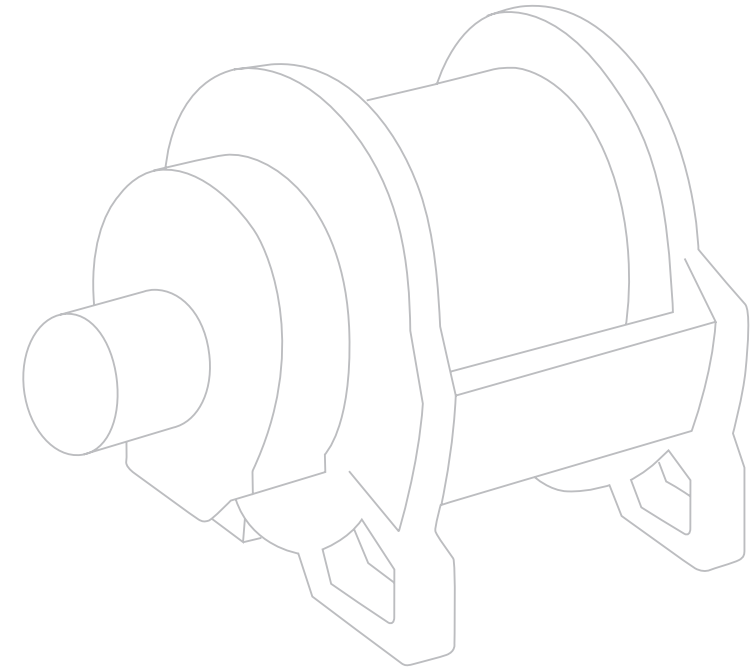

## 4. Performance Data, Dimensions, Order Codes

### Dimensions basic

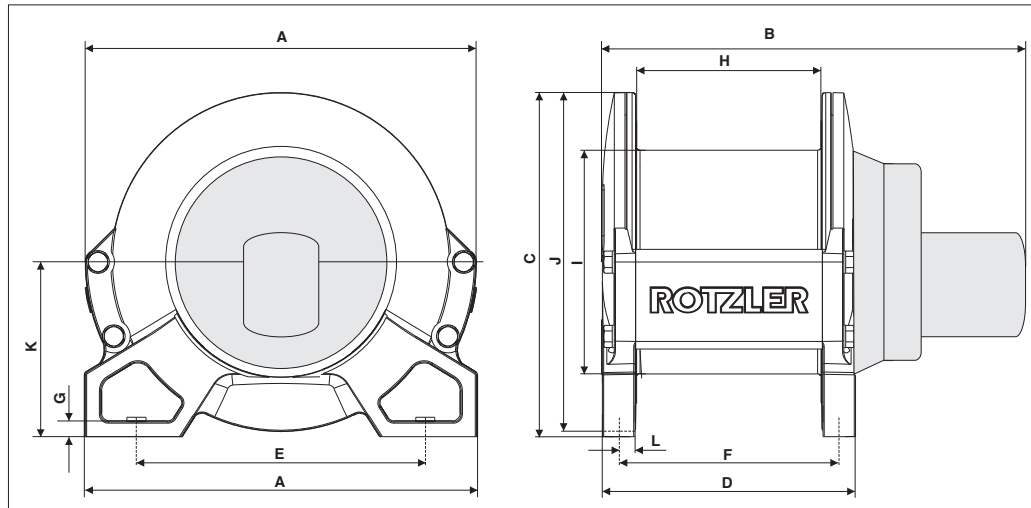

### ... with options and accessories

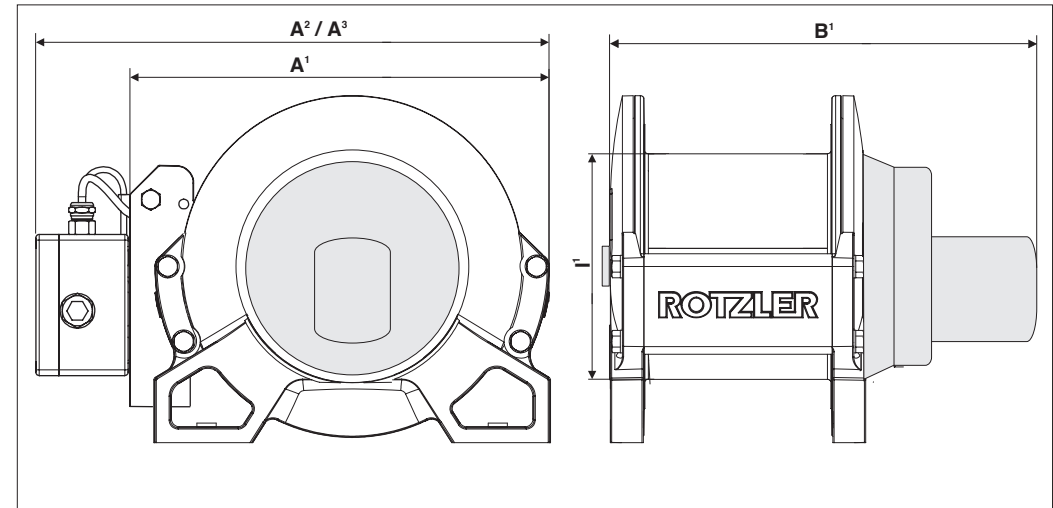

motor G096 / standard drum	A	A <sup>1</sup>	A <sup>2</sup>	A <sup>3</sup>	B	B <sup>1</sup>	C	D	E	F	G	H	I	I <sup>1</sup>	J	K	L
dimensions imperial – inches	19.9	20.4	23.5	22.6	25.1	25.5	17.1	15.6	14.2	13.8	0.8	12.2	11.0	11.6	16.7	8.6	0.9
dimensions metric – mm	max. 505	max. 517	max. 597	max. 575	636	646	433	max. 395	360.7	351.5	20.4	309.4	279.4	295.4	424.4	218	20.3
motor G0107 / standard drum	A	A <sup>1</sup>	A <sup>2</sup>	A <sup>3</sup>	B	B <sup>1</sup>	C	D	E	F	G	H	I	I <sup>1</sup>	J	K	L
dimensions imperial – inches	19.9	20.4	23.5	22.6	25.4	25.8	17.1	15.6	14.2	13.8	0.8	12.2	11.0	11.7	16.7	8.6	0.9
dimensions metric – mm	max. 505	max. 517	max. 597	max. 575	645	655	max. 433	max. 395	360.7	351.5	20.4	309.4	279.4	295.4	423.4	218	20.3

A<sup>1</sup> = with MCD 1 / pressure roller

A<sup>2</sup> = with MCD step 2 or 3

A<sup>3</sup> = with MCD step 4 or 5

B<sup>1</sup> = with MCD step 2, 3, 4 or 5

I<sup>1</sup> = with grooves

# 4. Performance Data, Dimensions, Order Codes

## Order code

2.TH.50.CC.G096.00.0.0000.0.00.0.DIG

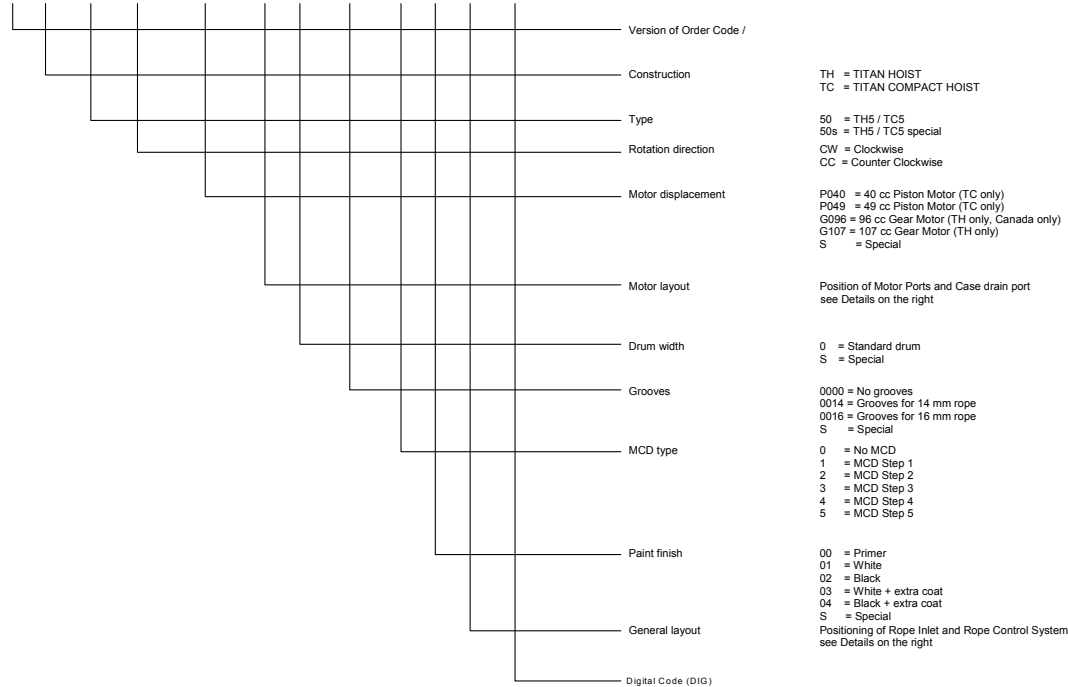

Binary Code	parameter
1	0 Without Counterbalance Valve
	1 With Counterbalance Valve (TC only)
2	0 Standard fasteners
	1 Stainless fasteners
4	0 Without Pressure Roller
	1 With Pressure Roller
8	0 Without External Brake Release
	1 With External Brake Release (TC)
16	0 Without External Brake Release
	1 With External Brake Release (TH)
32	0 With gear oil
	1 Without gear oil
:	:

## General Layout

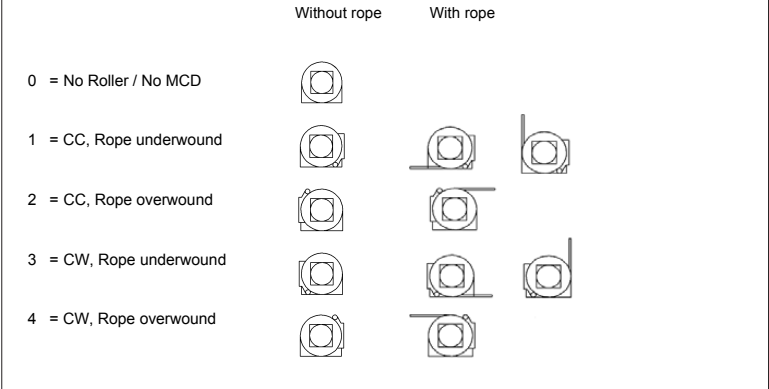

## Motor Layout

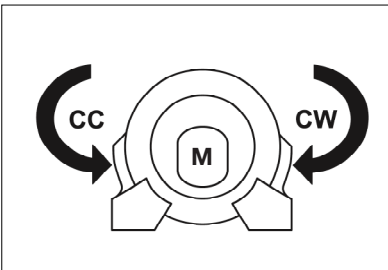
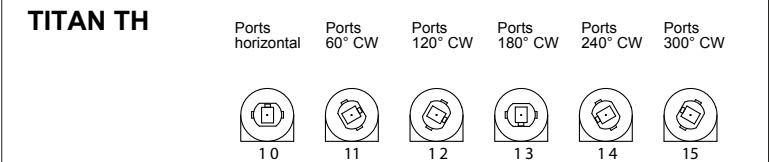

cc = counter clockwise  
cw = clockwise  
M = motor