

4. Performance Data, Dimensions, Order Codes

Motor

	motor G019		motor G031	
maximum pressure	4000 psi	275 bar**	2600 psi	170 bar*
maximum return flow pressure	300 psi	20 bar	300 psi	20 bar
maximum back pressure	75 psi	5 bar	75 psi	5 bar
maximum case drain pressure	300 psi	20 bar	300 psi	20 bar
maximum oil flow	14 USGPM	51 l/min	22 USGPM	83 l/min
minimum oil flow	4 USGPM	12 l/min	6 USGPM	20 l/min
weight (drum 180)	170 lbs	77 kg	170 lbs	77 kg

*including 10 bar return flow pressure allowance.
 For other return flow pressure values adjust maximum pressure accordingly.
 For other motor variants, please refer to factory.

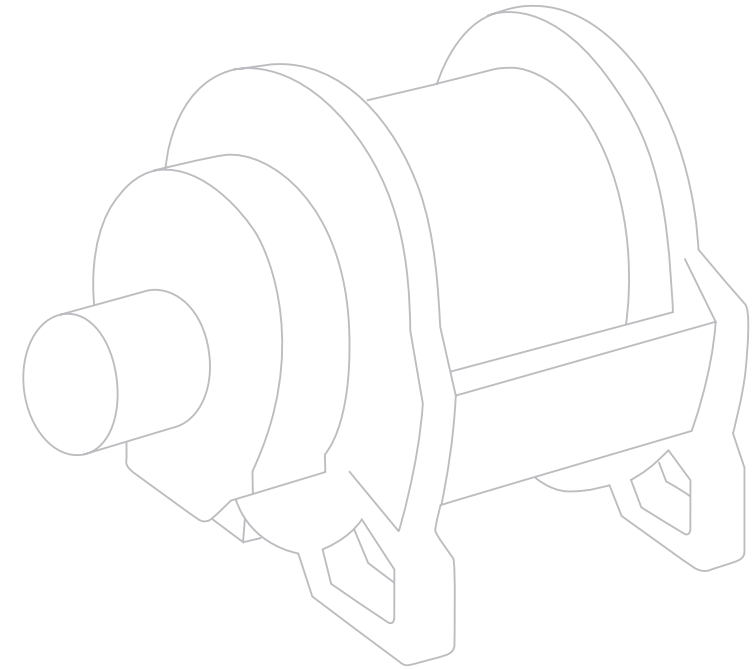

Drum

DRUM options		standard drum				
rope diameter range		1/4" - 1/2" / 6 - 12 mm				
imperial data based on rope diameter		3/8"				
metric data based on rope diameter		10 mm				
rope layer		1	2	3	4	5
max. hoisting force	lbs	4500	4100	3700	3500	3200
	kN	20	18	16.5	15	14
max. rope speed	ft/min	132	144	157	169	182
	m/min	40	44	48	52	56
accumulated rope storage	ft	37	77	120	166	215
	m	10	21	34	47	61

DRUM groove options		standard drum			
rope diameter		10 mm			
rope layer		1	2	3	4
max. hoisting force	kN	19	17	16	14.5
	m/min	42	46	50	54
accumulated rope storage	m	10	22	35	49

4. Performance Data, Dimensions, Order Codes

Dimensions basic

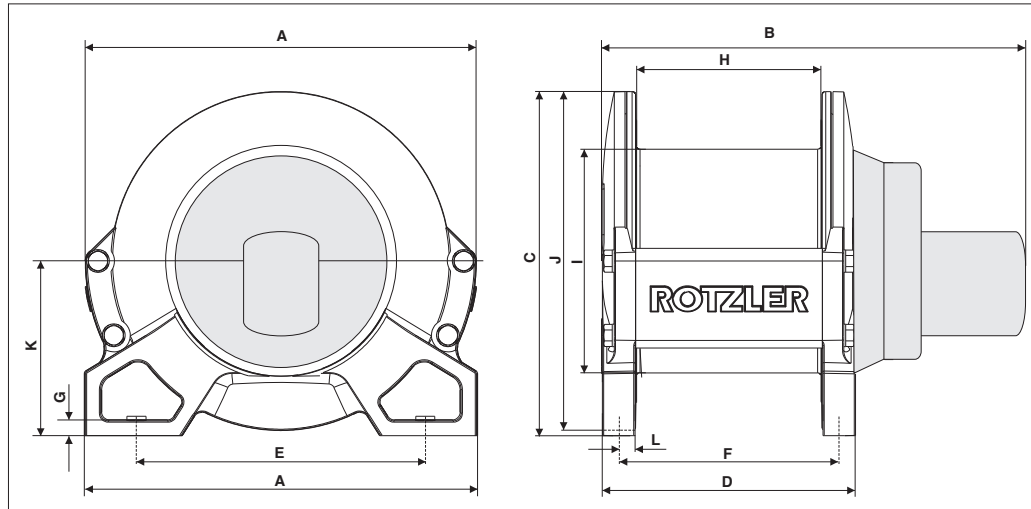

... with options and accessories

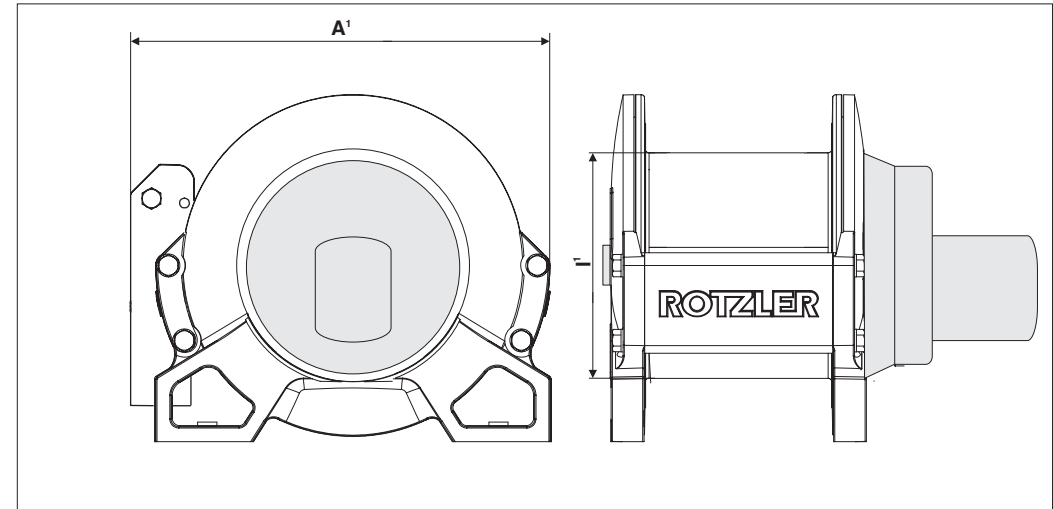

motor G019 / standard drum	A	A'	B	C	D	E	F	G	H	I	I'	J	K	L
dimensions imperial – inches	13.8	15.0	17.7	11.8	10.1	9.8	8.6	0.6	7.1	7.5	7.7	11.5	6.0	0.7
dimensions metric – mm	max. 350	max. 380	max. 450	max. 300	max. 256	248	219	14	180	190.5	200.5	292	152	17.6

motor G031 / standard drum	A	A'	B	C	D	E	F	G	H	I	I'	J	K	N
dimensions imperial – inches	13.8	15.0	18.5	11.8	10.1	9.8	8.6	0.6	7.1	7.5	7.9	11.5	6.0	0.7
dimensions metric – mm	max. 350	max. 380	max. 470	max. 300	max. 256	248	219	14	180	190.5	200.5	292	152	17.6

A' = with MCD 1 / pressure roller

I' = with grooves

4. Performance Data, Dimensions, Order Codes

Order code

2.TH.20.CC.G019.00.0.0000.0.00.0.DIG

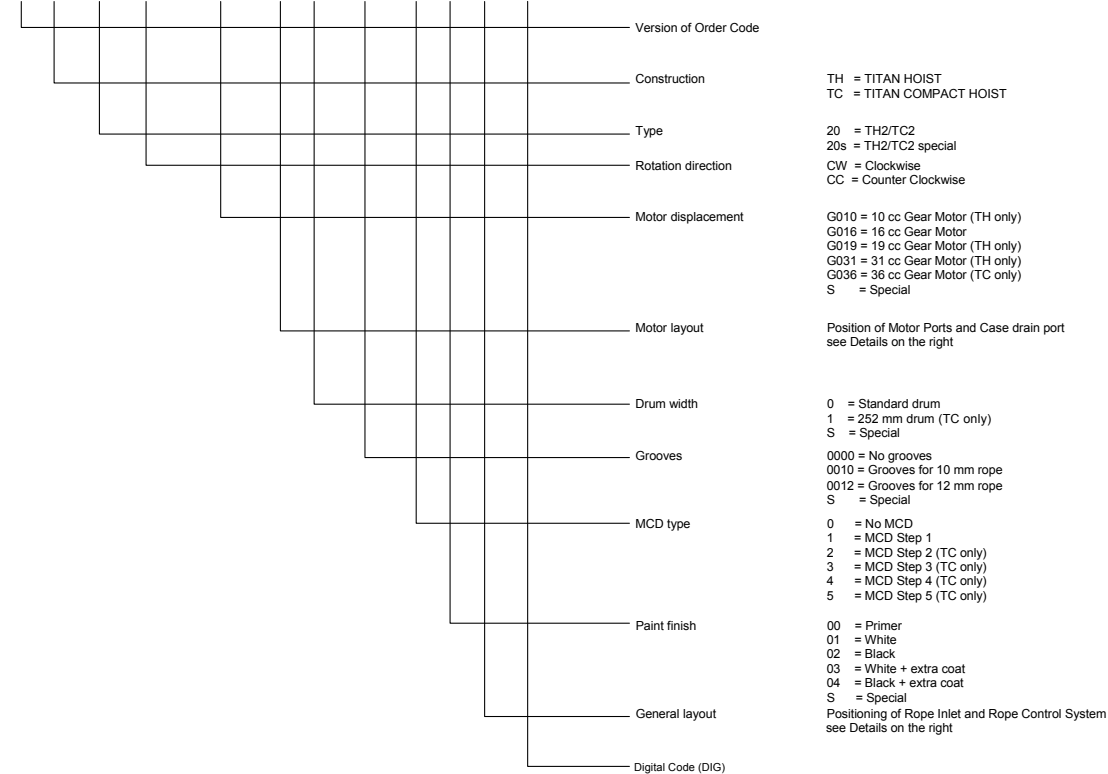

Binary Code	parameter
1	0 Without Counterbalance Valve
	1 With Counterbalance Valve (TC only)
2	0 Standard fasteners
	1 Stainless fasteners
4	0 Without Pressure Roller
	1 With Pressure Roller
8	0 Without External Brake Release
	1 With External Brake Release (TC)
16	0 Without External Brake Release
	1 With External Brake Release (TH)
32	0 With gear oil
	1 Without gear oil
∴	∴

