

4. Performance Data, Dimensions, Order Codes

Motor

	motor G010		motor G016		motor G019	
maximum pressure	4000 psi	275 bar*	2600 psi	175 bar*	2100 psi	150 bar
maximum return flow pressure	300 psi	20 bar	300 psi	20 bar	300 psi	20 bar
maximum back pressure	75 psi	5 bar	75 psi	5 bar	75 psi	5 bar
maximum case drain pressure	300 psi	20 bar	300 psi	20 bar	300 psi	20 bar
maximum oil flow	6.5 USGPM	25 l/min	11 USGPM	39 l/min	13 USGPM	46 l/min
minimum oil flow	1.6 USGPM	6 l/min	2.6 USGPM	10 l/min	2.6 USGPM	10 l/min
weight (drum 153)	126 lbs	57 kg	126 lbs	57 kg	126 lbs	57 kg

*including 10 bar return flow pressure allowance.
For other return flow pressure values adjust maximum pressure accordingly.
For other motor variants, please refer to factory.

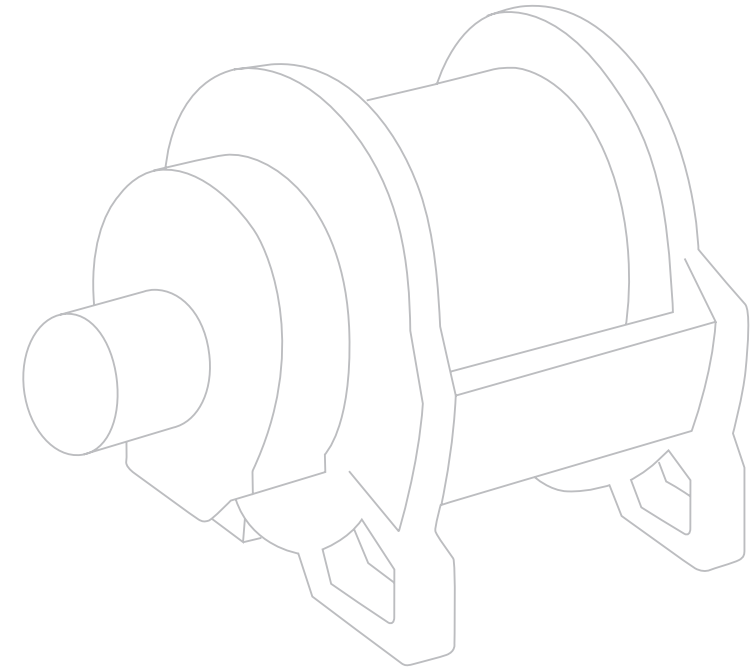

Drum

DRUM options		standard drum				
rope diameter range		3/16" - 3/8" / 5 - 9 mm				
imperial data based on rope diameter		5/16"				
metric data based on rope diameter		8 mm				
rope layer		1	2	3	4	5
max. hoisting force	lbs	2200	2000	1800	1700	1600
	kN	10	9	8.5	7.5	7
max. rope speed	ft/min	126	136	147	158	169
	m/min	38	41	45	48	51
accumulated rope storage	ft	34	72	112	155	200
	m	10	21	33	45	58

DRUM groove options		standard drum			
rope diameter		8 mm			
rope layer		1	2	3	4
max. hoisting force	kN	9.5	8.5	8	7.5
	m/min	40	43	47	50
accumulated rope storage	m	10	22	34	47

4. Performance Data, Dimensions, Order Codes

Dimensions basic

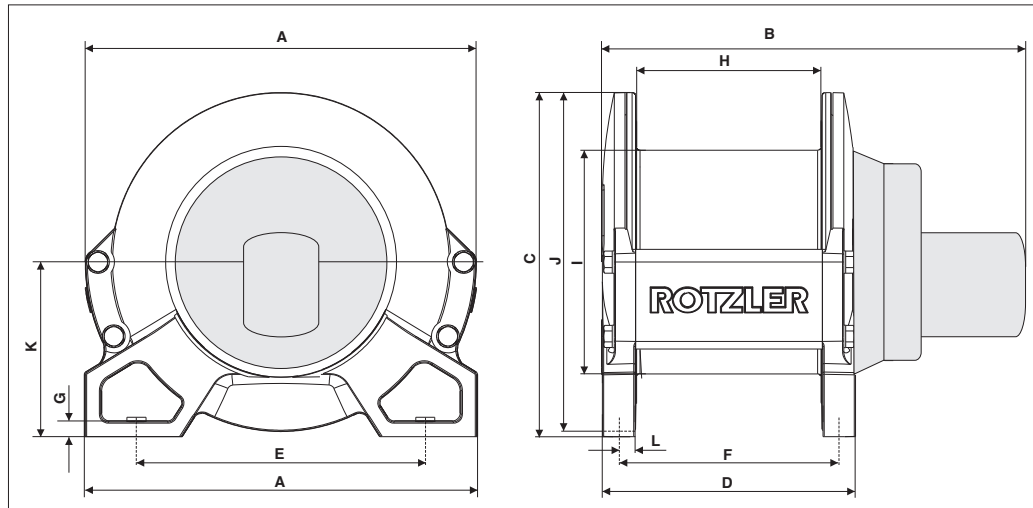

... with options and accessories

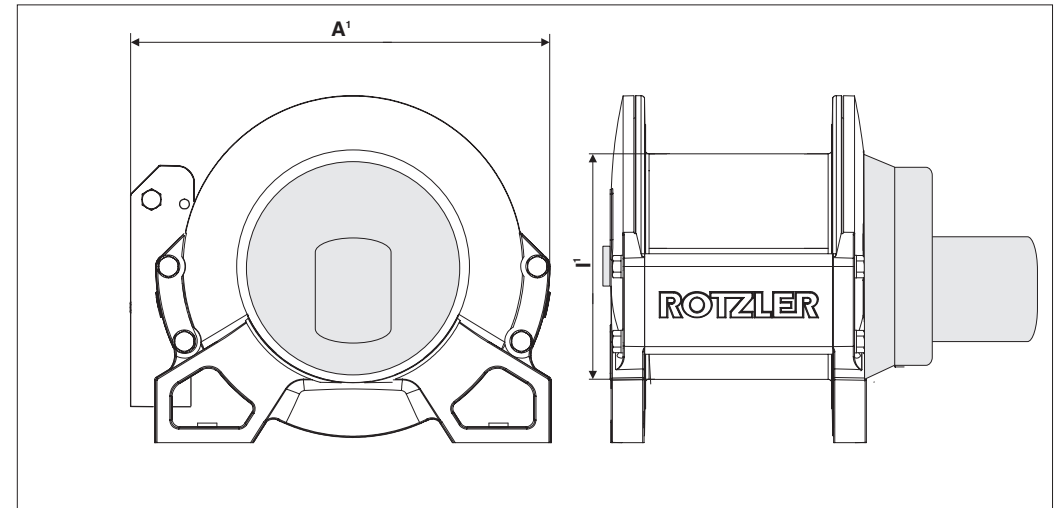

motor G010 / standard drum

dimensions imperial – inches
dimensions metric – mm

A	A'	B	C	D	E	F	G	H	I	I'	J	K	L
12.6	13.46	15.5	11.0	8.5	9.0	7.2	0.5	6.0	7.0	7.4	10.6	5.6	0.6
max. 320	max. 342	400	280	215	230	184	12.7	153	178	187.8	270	141	15.5

motor G016 / standard drum

dimensions imperial – inches
dimensions metric – mm

A	A'	B	C	D	E	F	G	H	I	I'	J	K	L
12.4	13.46	16.1	11.0	8.5	9.0	7.2	0.5	6.0	7.0	7.4	10.6	5.6	0.6
max. 320	max. 342	410	280	215	230	184	12.7	153	178	187.8	270	141	15.5

motor G019 / standard drum

dimensions imperial – inches
dimensions metric – mm

A	A'	B	C	D	E	F	G	H	I	I'	J	K	L
12.6	13.46	16.3	11.0	8.5	9.0	7.2	0.5	6.0	7.0	7.4	10.6	5.6	0.6
max. 320	max. 342	415	280	215	230	184	12.7	153	178	187.8	270	141	15.5

A' = with MCD 1 / pressure roller

I' = with grooves

4. Performance Data, Dimensions, Order Codes

Order code

2.TH.10.CC.G016.00.0.0000.0.00.0.DIG

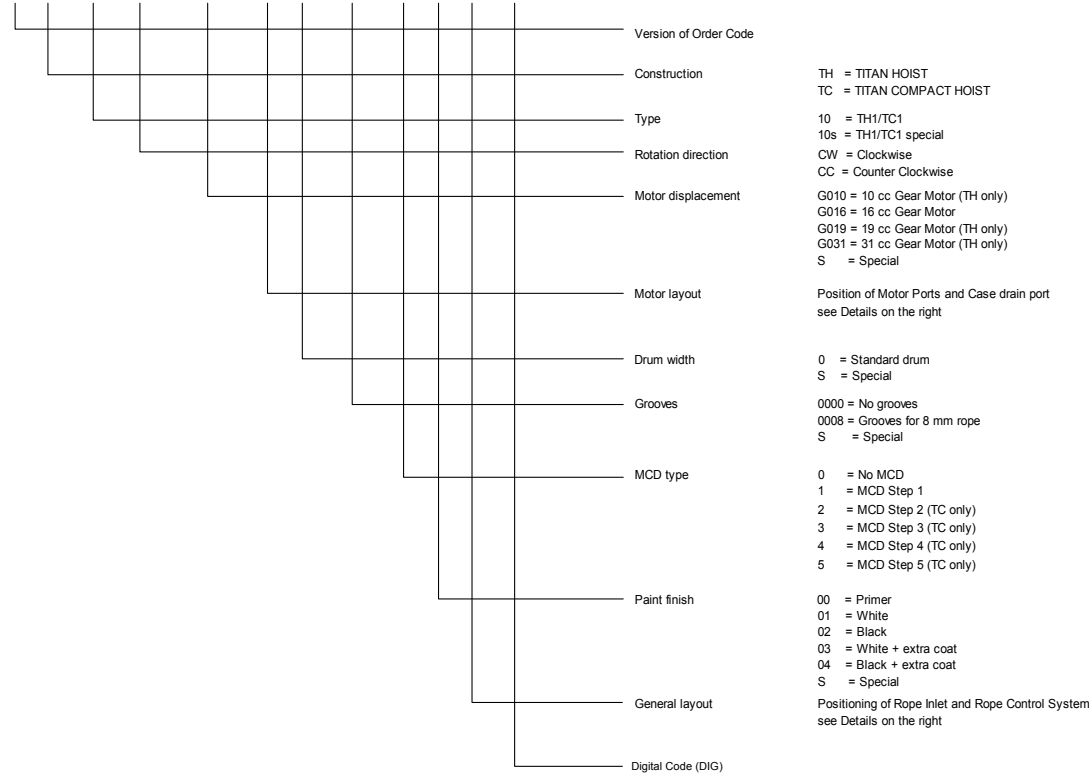

Binary Code	parameter
1	0 Without Counterbalance Valve
	1 With Counterbalance Valve (TC only)
2	0 Standard fasteners
	1 Stainless fasteners
4	0 Without Pressure Roller
	1 With Pressure Roller
8	0 Without External Brake Release
	1 With External Brake Release (TC)
16	0 Without External Brake Release
	1 With External Brake Release (TH)
32	0 With gear oil
	1 Without gear oil
⋮	⋮

