

4. Performance Data, Dimensions, Order Codes

Motor

motor G036

maximum pressure	2800 psi	190 bar*
maximum return flow pressure	300 psi	20 bar
maximum back pressure	75 psi	5 bar
maximum case drain pressure	300 psi	20 bar
maximum oil flow	26 USGPM	97 l/min
minimum oil flow	6 USGMPM	20 l/min
weight (drum 180)	ca. 165 lbs	ca. 75 kg
weight (drum 252)	ca. 210 lbs	ca. 95 kg

*including 10 bar return flow pressure allowance.
For other return flow pressure values adjust maximum pressure accordingly.
For other motor variants, please refer to factory.

Drum

DRUM options

standard drum

rope diameter range		1/4" - 1/2" / 6 - 12 mm				
imperial data based on rope diameter		3/8"				
metric data based on rope diameter		10 mm				
rope layer		1	2	3	4	5
max. hoisting force	lbs	6000	5400	5000	4600	4300
	kN	26	24	22	20	19
max. rope speed	ft/min	132	144	157	169	182
	m/min	40	44	48	52	56
accumulated rope storage	ft	36	76	119	165	214
	m	10	22	35	49	62

DRUM groove options

standard drum

drum 252 (TC 2L)

		10 mm				10 mm			
		1	2	3	4	1	2	3	4
rope diameter									
rope layer									
max. hoisting force	lbs	5700	5200	4800	4400	5700	5200	4800	4400
	kN	25	23	21	20	25	23	21	20
max. rope speed	ft/min	139	152	165	178	139	152	165	178
	m/min	42	46	50	54	42	46	50	54
accumulated rope storage	ft	35	74	116	161	51	106	165	229
	m	10	22	34	48	15	32	50	69

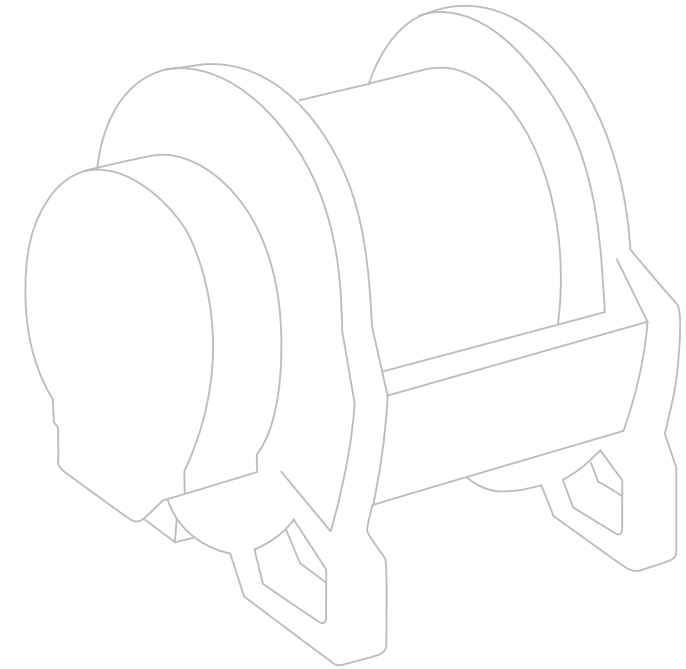

4. Performance Data, Dimensions, Order Codes

Dimensions basic

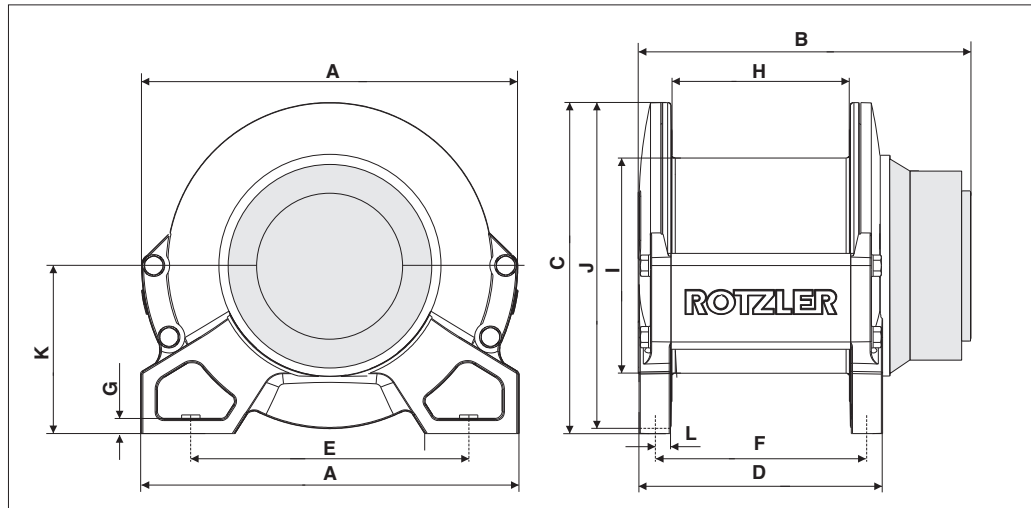

... with options and accessories

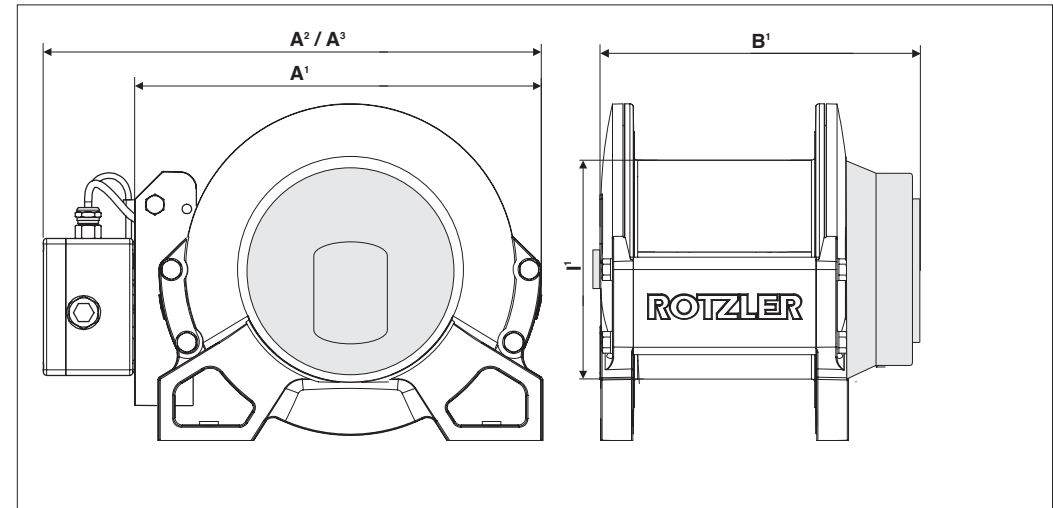

motor G036 / standard drum	A	A¹	A²	A³	B	B¹	C	D	E	F	G	H	I	I¹	J	K	L
dimensions imperial – inches	13.8	15.0	18.3	17.3	14.8	15.2	11.8	10.1	9.7	8.6	0.6	7.2	7.5	7.7	11.5	6.0	0.7
dimensions metric – mm	max. 350	max. 380	max. 465	max. 440	max. 375	max. 385	max. 300	max. 256	247.5	219	14.0	180.0	190.5	200.5	292	152	17.6
motor G036 / drum 252 (TC 2L)	A	A¹	A²	A³	B	B¹	C	D	E	F	G	H	I	I¹	J	K	L
dimensions imperial – inches	13.8	15.0	18.3	17.3	17.7	18.1	11.8	13.0	9.7	11.6	0.6	9.9	N/A	7.7	11.5	6.0	0.7
dimensions metric – mm	max. 350	max. 380	max. 465	max. 440	max. 450	max. 460	max. 300	max. 330	247.5	292.5	14.0	252	N/A	200.5	292	152	17.6

A¹ = with MCD 1 / pressure roller

A² = with MCD step 2 or 3

A³ = with MCD step 4 or 5

B¹ = with MCD step 2, 3, 4 or 5

I¹ = with grooves

4. Performance Data, Dimensions, Order Codes

TITAN TH 1 TH 2 TH 3 TH 5 TC 1 **TC 2** TC 3 TC 5 winches

Order code

2.TC.20.CC.G036.00.0.0000.0.00.0.DIG

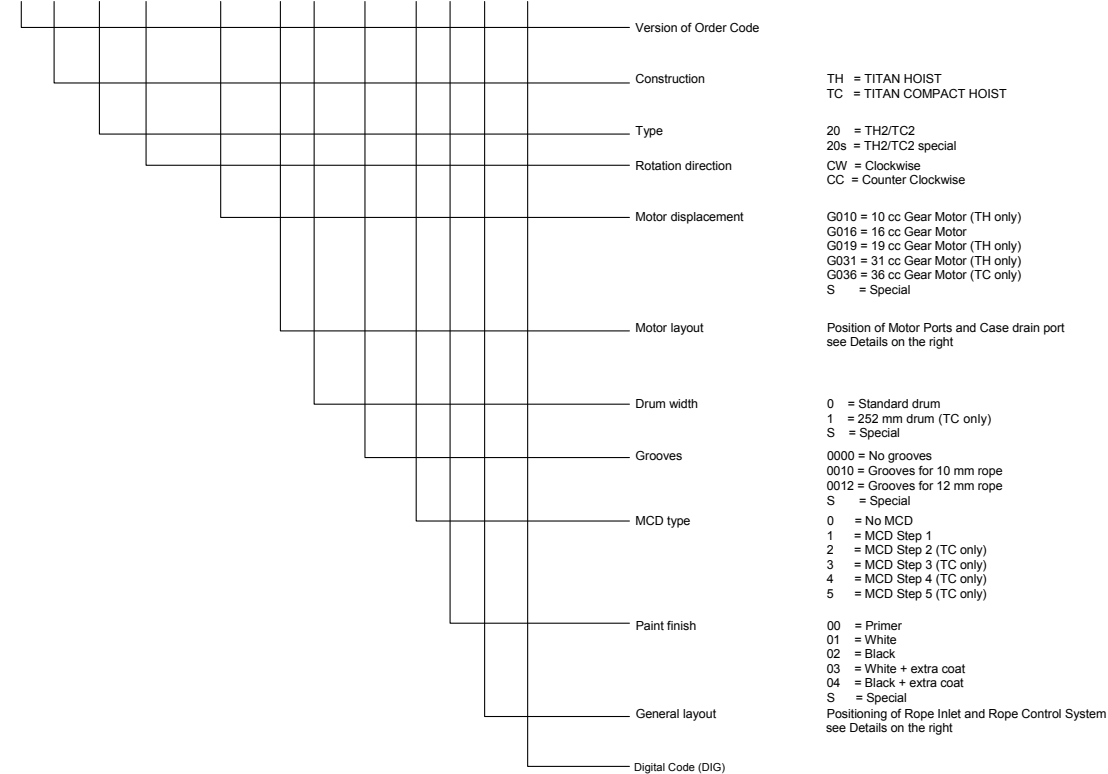

Binary Code	parameter
1	0 Without Counterbalance Valve
	1 With Counterbalance Valve (TC only)
2	0 Standard fasteners
	1 Stainless fasteners
4	0 Without Pressure Roller
	1 With Pressure Roller
8	0 Without External Brake Release
	1 With External Brake Release (TC)
16	0 Without External Brake Release
	1 With External Brake Release (TH)
32	0 With gear oil
	1 Without gear oil
⋮	⋮

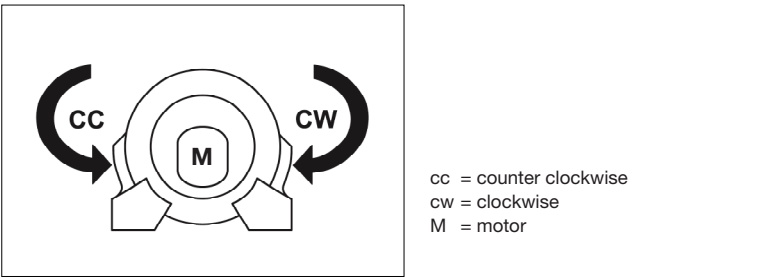
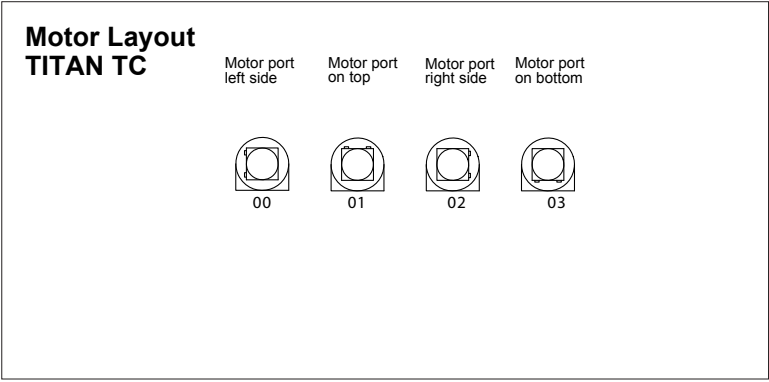
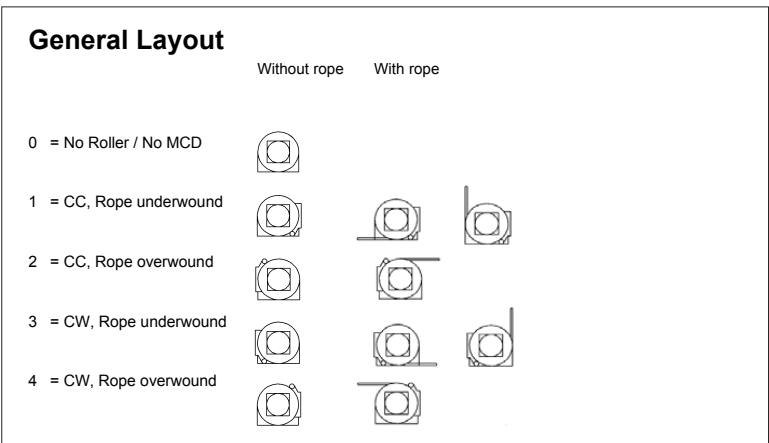

ROTZLER TITAN Hoisting winches – Technical product information 07.10 Technical data are subject to change without notice.