

## Patriot Profile 9500

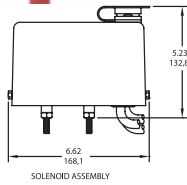

Dimensions are the same for Patriot Profile 9500 and 9000

## Patriot Profile 9000

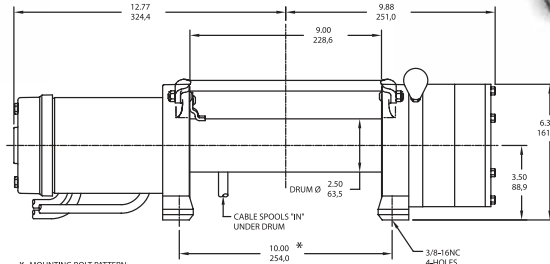

\* MOUNTING BOLT PATTERN:  
FOUR Ø.41 HOLES IN A 4.875±.015 x 4.50±.015 RECTANGULAR PATTERN.

Note: Fairlead does not attach directly to winch. Dimensions shown are inches over millimeters.

Product Features

- Efficient 5.5 HP\* 12 V DC series wound electric reversible motor for increased pulling power (*Patriot Profile 9000 uses a 4.4 HP motor*)
- Proven three-stage planetary gear system design for fast line speed
- Motor and solenoids are grounded directly to battery
- Strong automatic load-holding brake for strength
- Cam action clutch disengages planetary gear system for free spooling
- Weather resistant solenoid assembly
- The Patriot Profile Series comes with either a 12 ft pendant or the patented (US # 6,995,682) wireless remote
- 6 ft (1,83 m) 2 gauge battery cables with connectors
- 4-way roller fairlead
- Limited lifetime warranty

### Specifications

Rated line pull . . . . . (single line) 9,500 lb (4,309 kg)  
 Gear reduction ratio . . . . . 138:1 (12V)  
 Motor . . . . . Series wound - 5.5 hp 12V DC  
 Overall dimensions . . . . . (LxWxH) 22.65" x 6.62" x 6.10"  
 (575.4 mm x 168.1 mm x 154.9 mm)  
 Drum size . . . . . Diameter 2.5" (63 mm) Length 9" (228 mm)  
 Weight . . . . . 92 lb (41.7 kg)  
 Cable supplied . . . . . 105 ft (31,8 m) of 5/16" (8 mm) galvanized aircraft cable with replaceable clevis hook with safety latch  
 Mounting bolt pattern . . . . . 10.00 ± .015 in. x 4.50 ± .015 in.  
 (254,0 mm x 114,3 mm)

### Line Speed and Amp Draw – First Layer

Line Pull	lb	kg	no load	2,000 900	4,000 1,810	6,000 2,720	8,000 3,620	9,500 4,309
Line Speed	fpm		35.4	16.7	12.7	10.6	9.0	7.8
	mpm		10.7	5.1	3.8	3.2	2.7	2.3
Motor Current	amps	12V	97	180	260	335	395	430

### Line Pull and Cable Capacity

Layer of Cable		1	2	3	4	5
Rated Line Pull per Layer	lb	9,500	7,780	6,600	5,725	5,050
	kg	4,309	3,528	2,993	2,596	2,290
Cable Capacity per Layer	ft	15	35	60	90	105
	m	4	10	18	27	32

- Patriot Profile 9500 R 12V with 12 ft pendant . . . . . **Part# 109167**
- Patriot Profile 9500 R 12V with wireless remote . . . . . **Part# 109168**
- Patriot Profile 9500 R 24V with 12 ft pendant . . . . . **Part# 109175**
- Patriot Profile 9500 R 12V CE with 12 ft pendant . . . . . **Part# 109180**
- R - 4-way roller fairlead

### Specifications

Rated line pull . . . . . (single line) 9,000 lb (4,070 kg)  
 Gear reduction ratio . . . . . 138:1 (12V)  
 Motor . . . . . Series wound - 4.4 hp 12V DC  
 Overall dimensions . . . . . (LxWxH) 22.65" x 6.62" x 6.10"  
 (575.4 mm x 168.1 mm x 154.9 mm)  
 Drum size . . . . . Diameter 2.5" (63 mm) Length 9" (228 mm)  
 Weight . . . . . 92 lb (41.7 kg)  
 Cable supplied . . . . . 105 ft (31,8 m) of 5/16" (8 mm) galvanized aircraft cable with replaceable clevis hook with safety latch  
 Mounting bolt pattern . . . . . 10.00 ± .015 in. x 4.50 ± .015 in.  
 (254,0 mm x 114,3 mm)

### Line Speed and Amp Draw – First Layer

Line Pull	lb	kg	no load	2,000 900	4,000 1,810	6,000 2,720	9,000 4,070
Line Speed	fpm		29	15	11	9	7
	mpm		8.8	4.6	3.4	2.7	2.1
Motor Current	amps	12V	90	190	245	315	400

### Line Pull and Cable Capacity

Layer of Cable		1	2	3	4	5
Rated Line Pull per Layer	lb	9,000	7,300	6,200	5,400	4,700
	kg	4,070	3,300	2,800	2,440	2,130
Cable Capacity per Layer	ft	15	40	70	95	105
	m	4	12	21	28	32

- Patriot Profile 9000 R 12V with 12 ft pendant . . . . . **Part# 109165**
- Patriot Profile 9000 R 12V with wireless remote . . . . . **Part# 109166**
- R - 4-way roller fairlead