

## 4. Performance Data, Dimensions, Order Codes

### Motor

#### motor G057

maximum pressure	3300 psi	225 bar*
maximum return flow pressure	200 psi	14 bar
maximum back pressure	60 psi	4 bar
maximum case drain pressure	200 psi	14 bar
maximum oil flow	40 USGPM	150 l/min
minimum oil flow	6 USGPM	20 l/min
weight (drum 230)	400 lbs	181 kg

\*including 10 bar return flow pressure allowance.  
For other return flow pressure values adjust maximum pressure accordingly.  
For other motor variants, please refer to factory.

### Drum

#### DRUM options

#### standard drum

rope diameter range		3/8" - 5/8" / 10 - 16 mm				
imperial data based on rope diameter		9/16"				
metric data based on rope diameter		14 mm				
rope layer		<b>1</b>	<b>2</b>	<b>3</b>	<b>4</b>	<b>5</b>
max. hoisting force	lbs	9200	8400	7700	7100	-
	kN	41	37	34	32	29
max. rope speed	ft/min	144	158	172	186	-
	m/min	44	48	52	56	60
accumulated rope storage	ft	45	95	148	206	-
	m	14	29	46	63	82

#### DRUM groove options

#### standard drum

rope diameter		14 mm			
rope layer		<b>1</b>	<b>2</b>	<b>3</b>	<b>4</b>
max. hoisting force	lbs	8700	8000	7400	6800
	kN	39	35	33	30
max. rope speed	ft/min	152	166	179	193
	m/min	46	50	54	59
accumulated rope storage	ft	47	99	154	213
	m	14	30	47	65

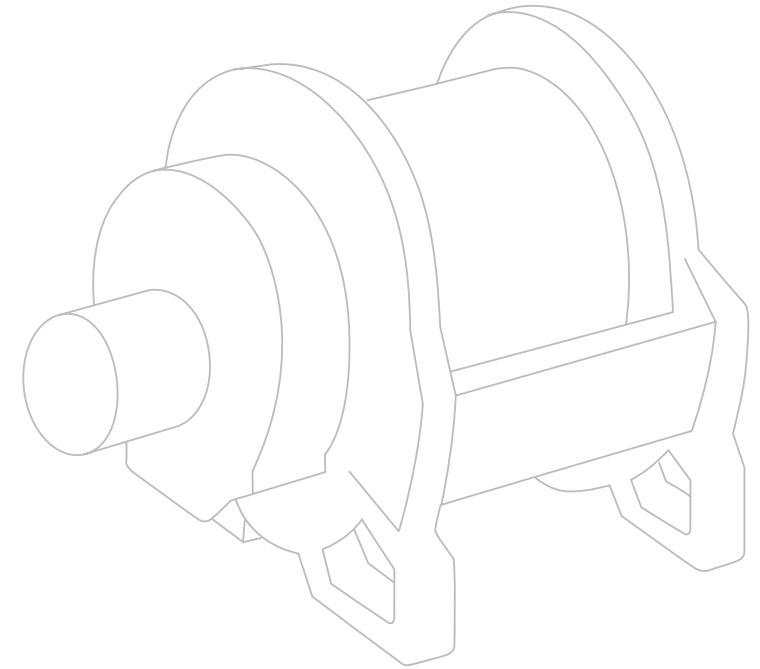

## 4. Performance Data, Dimensions, Order Codes

### Dimensions basic

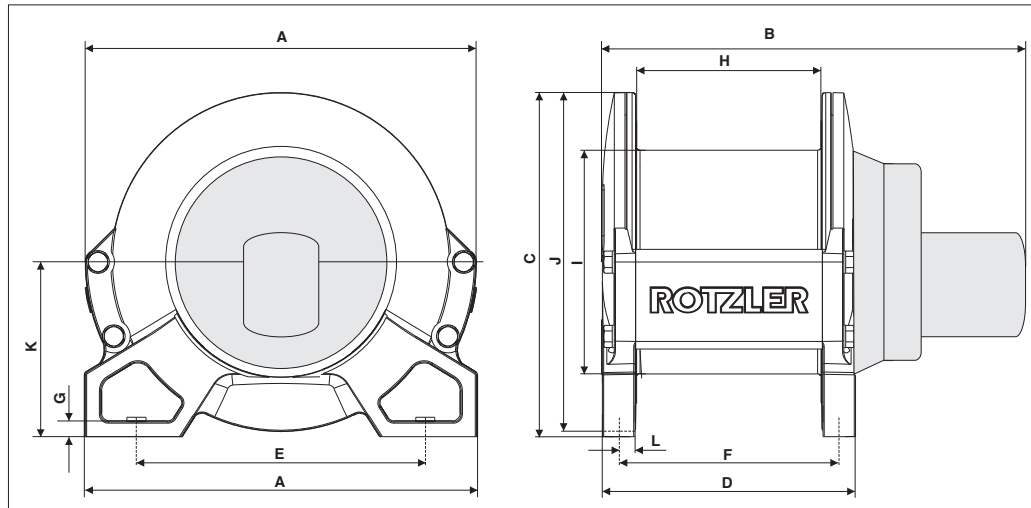

### ... with options and accessories

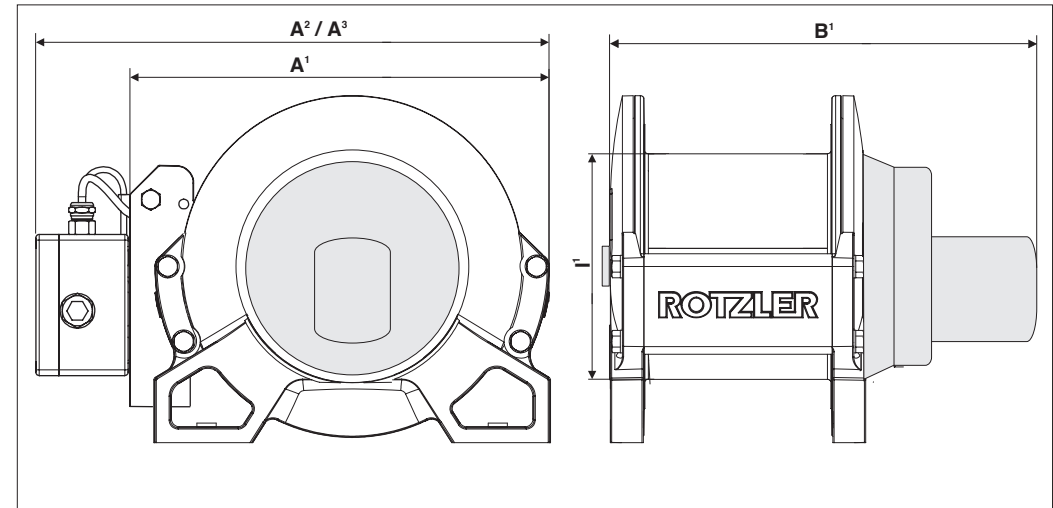

motor G057 / standard drum	A	A <sup>1</sup>	A <sup>2</sup>	A <sup>3</sup>	B	B <sup>1</sup>	C	D	E	F	G	H	I	I <sup>1</sup>	J	K	L
dimensions imperial – inches	19.5	20.4	23.5	22.6	20.7	21.1	17.0	12.7	14.2	10.8	0.8	9.0	11	11.6	16.7	8.6	0.8
dimensions metric – mm	max. 495	max. 517	max. 597	max. 575	max. 526	max. 536	max. 433	max. 323	360.7	275.3	20.4	228.5	279.4	295.4	423.4	218	20.3

- A<sup>1</sup> = with MCD 1 / pressure roller
- A<sup>2</sup> = with MCD step 2, 3
- A<sup>3</sup> = with MCD step 4, 5
- B<sup>1</sup> = with MCD step 2, 3, 4 or 5
- I<sup>1</sup> = with grooves

ROTZLER TITAN Hoisting winches – Technical product information 07.10 Technical data are subject to change without notice.

# 4. Performance Data, Dimensions, Order Codes

## Order code

2.TH.30.CC.G057.00.0.0000.0.00.0.DIG

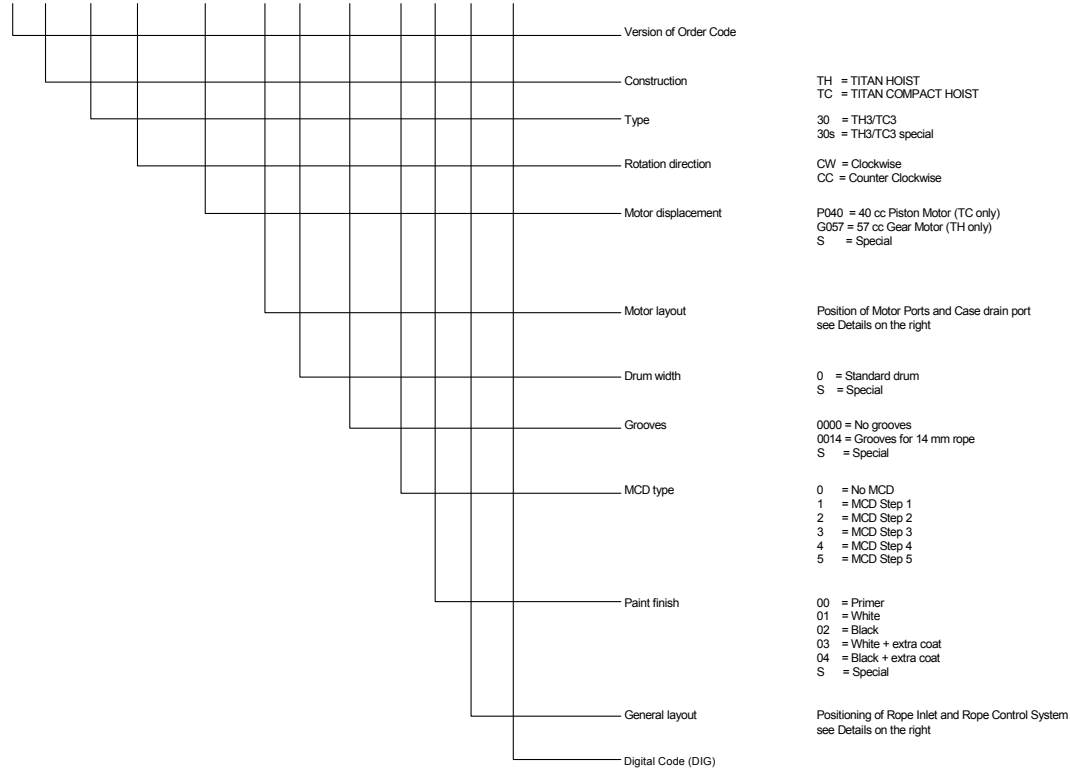

Binary Code	parameter
1	0 Without Counterbalance Valve
	1 With Counterbalance Valve (TC only)
2	0 Standard fasteners
	1 Stainless fasteners
4	0 Without Pressure Roller
	1 With Pressure Roller
8	0 Without External Brake Release
	1 With External Brake Release (TC)
16	0 Without External Brake Release / Ohne externe Bremsbelüftung
	1 With External Brake Release (TH)
32	0 With gear oil
	1 Without gear oil
⋮	⋮

## General Layout

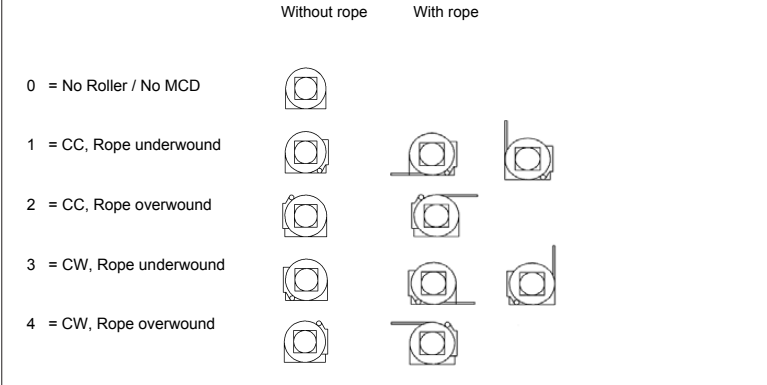

## Motor Layout TITAN TH

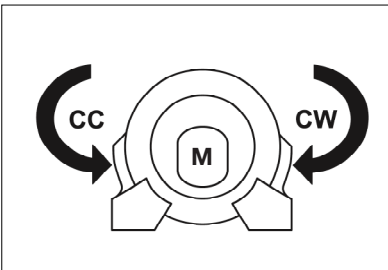
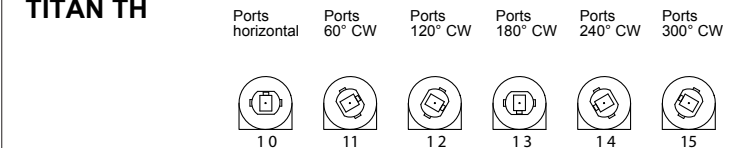

cc = counter clockwise  
 cw = clockwise  
 M = motor