

4. Performance Data, Dimensions, Order Codes

Motor

motor G016

maximum pressure	3200 psi	220 bar*
maximum return flow pressure	300 psi	20 bar
maximum back pressure	75 psi	5 bar
maximum case drain pressure	300 psi	20 bar
maximum oil flow	11 USGPM	40 l/min
minimum oil flow	2.6 USGPM	10 l/min
weight (drum 153)	110 lbs	50 kg

*including 10 bar return flow pressure allowance.
For other return flow pressure values adjust maximum pressure accordingly.
For other motor variants, please refer to factory.

Drum

DRUM options

standard drum

rope diameter range	5 - 9 mm					
data based on rope diameter	8 mm					
rope layer	1	2	3	4	5	
max. hoisting force	kN	12.5	11.5	10.5	10	9
max. rope speed	m/min	39	43	46	50	53
accumulated rope storage	m	10	21	33	45	58

DRUM groove options

standard drum

rope diameter	8 mm				
rope layer	1	2	3	4	
max. hoisting force	kN	11.5	11	10	9.5
max. rope speed	m/min	42	45	48	52
accumulated rope storage	m	10	22	34	47

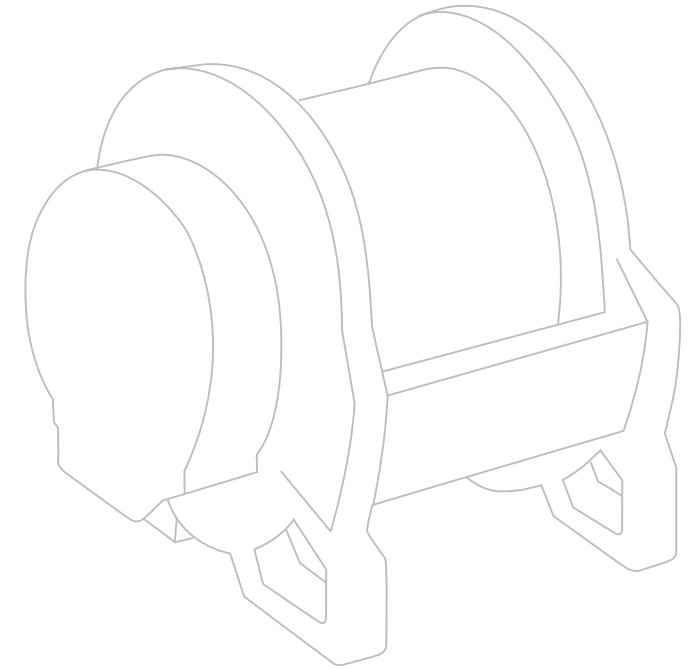

4. Performance Data, Dimensions, Order Codes

Dimensions basic

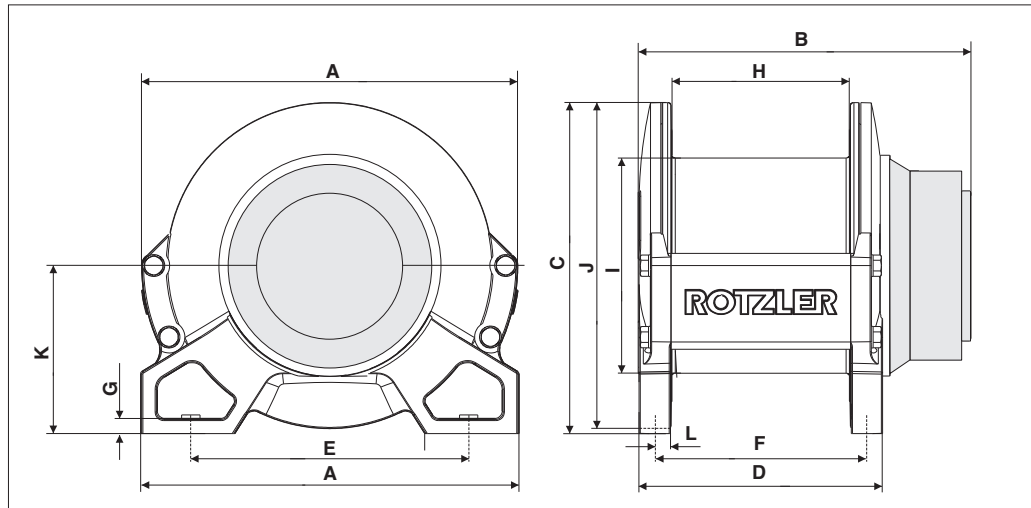

... with options and accessories

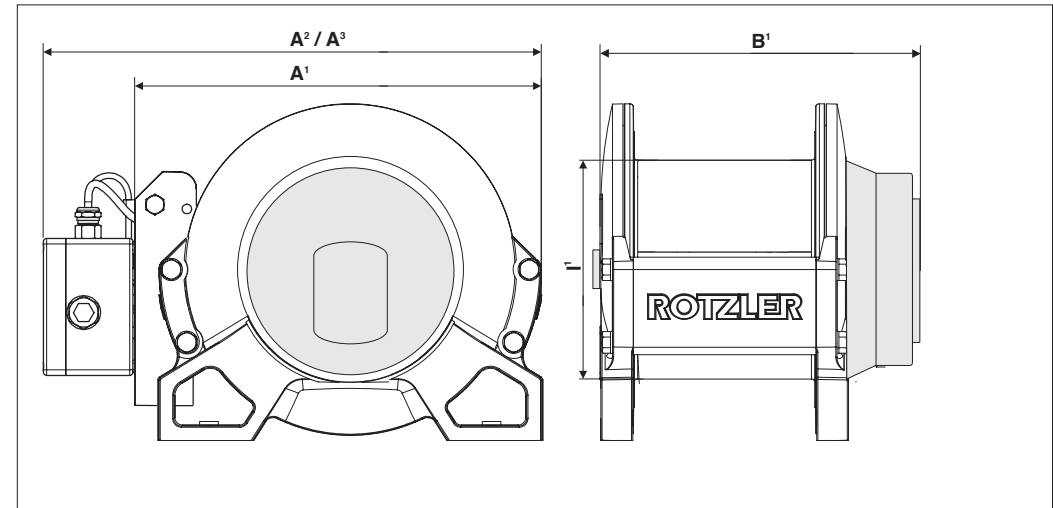

motor G016 / standard drum	A	A ¹	A ²	A ³	B	B ¹	C	D	E	F	G	H	I	I ¹	J	K	L
dimensions imperial – inches	12.6	13.5	16.6	15.8	11.4	11.6	11.0	8.5	9.0	7.3	0.5	6.1	7.0	7.4	10.7	5.6	0.6
dimensions metric – mm	max. 320	max. 342	max. 422	max. 400	max. 290	max. 300	max. 280	max. 215	230	184	12.7	153	178	187.8	270	141	15.5

- A¹ = with MCD 1 / pressure roller
- A² = with MCD step 2 or 3
- A³ = with MCD step 4 or 5
- B¹ = with MCD step 2, 3, 4 or 5
- I¹ = with grooves

ROTZLER TITAN Hoisting winches – Technical product information 07.10 Technical data are subject to change without notice.

4. Performance Data, Dimensions, Order Codes

Order code

2.TC.10.CC.G016.00.0.0000.0.00.0.DIG

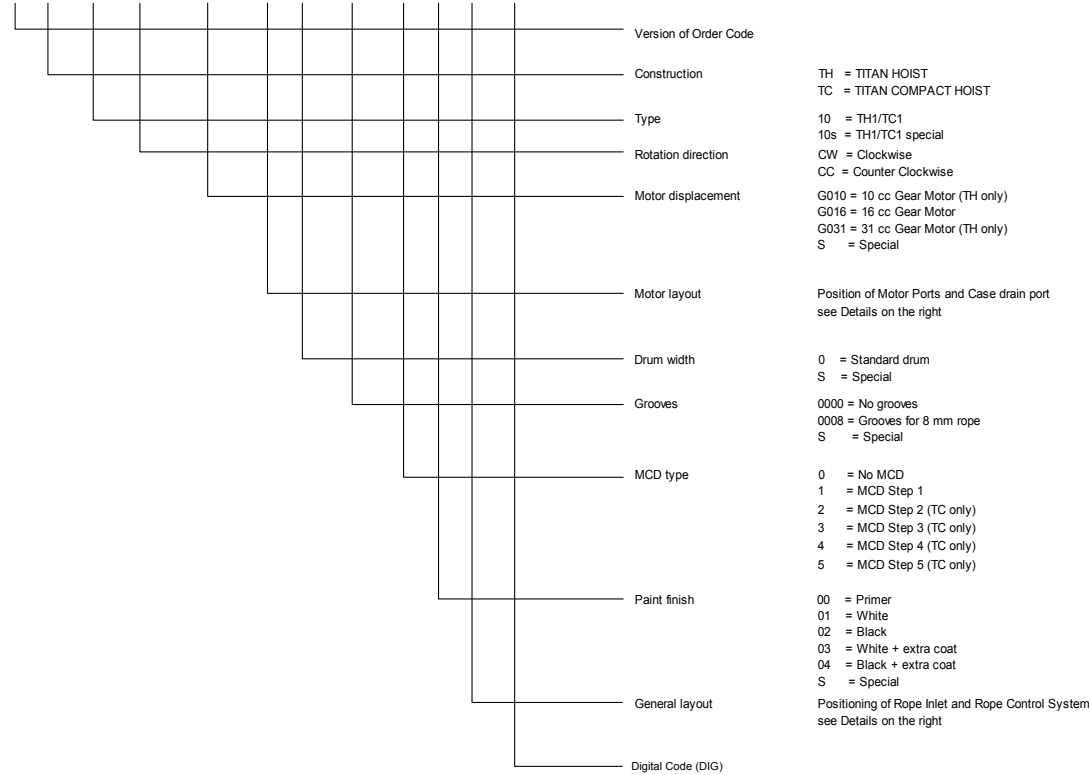

Binary Code	parameter
1	0 Without Counterbalance Valve
	1 With Counterbalance Valve (TC only)
2	0 Standard fasteners
	1 Stainless fasteners
4	0 Without Pressure Roller
	1 With Pressure Roller
8	0 Without External Brake Release
	1 With External Brake Release (TC)
16	0 Without External Brake Release
	1 With External Brake Release (TH)
32	0 With gear oil
	1 Without gear oil
⋮	⋮

